

位置 LOCATION

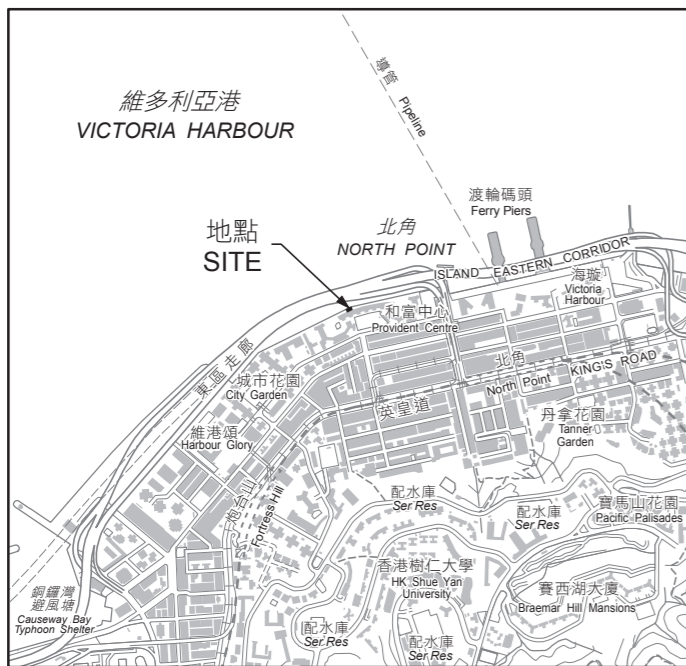

比例 SCALE 1:20 000

設定暫時佔用土地權利的範圍 AREA FOR CREATION OF RIGHTS OF TEMPORARY OCCUPATION OF LAND	
地段編號 LOT No.	面積以平方米計(約數) AREA IN SQUARE METRES (ABOUT)
內地段第8465號的一部分土地 A PORTION OF LAND IN INLAND LOT No. 8465	18.7

圖例
LEGEND

--- 地段界線
LOT BOUNDARY

紫色
Purple

設定暫時佔用土地權利的範圍
AREA FOR CREATION OF RIGHTS OF TEMPORARY OCCUPATION OF LAND

HKPD
香港主水平基準
HONG KONG PRINCIPAL DATUM

內地段第8465號的一部分土地的暫時佔用土地權利擬設定於香港主水平基準以上約5.5米及7.8米之間。
RIGHTS OF TEMPORARY OCCUPATION OF LAND IN A PORTION OF LAND IN INLAND LOT No. 8465 ARE PROPOSED TO BE CREATED FROM A LEVEL OF APPROXIMATELY 5.5 METRES ABOVE THE HONG KONG PRINCIPAL DATUM TO A LEVEL OF APPROXIMATELY 7.8 METRES ABOVE THE HONG KONG PRINCIPAL DATUM.

Signed

(梁妙燕 Karen M.Y. LEUNG)

總產業測量師/土地徵用 Chief Estate Surveyor / Acquisition
日期 Date 17 DEC 2020

地政總署 土地徵用組
Acquisition Section
Lands Department

圖則由港島測量處繪製
Plan Prepared by District Survey Office, Hong Kong
© 香港特別行政區政府 版權所有 Copyright reserved - Hong Kong SAR Government

設定暫時佔用土地權利圖則
道路(工程、使用及補償)條例(第370章)
工務計劃項目第7873TH號
東區走廊下之行人板道的道路工程

PLAN FOR CREATION OF RIGHTS OF TEMPORARY OCCUPATION OF LAND
ROADS (WORKS, USE AND COMPENSATION) ORDINANCE (CHAPTER 370)
ROAD WORKS UNDER PWP ITEM NO. 7873TH
BOARDWALK UNDERNEATH ISLAND EASTERN CORRIDOR

檔案編號 File No. DSO/HK W2879

測量圖編號 Survey Sheet No. 11-SE-1C

發展藍圖編號 Layout Plan No. --

參考圖編號 Reference Plan No. HKM10694.dgn

圖則編號 PLAN No. HKM10694

切面圖 SECTION A-A'

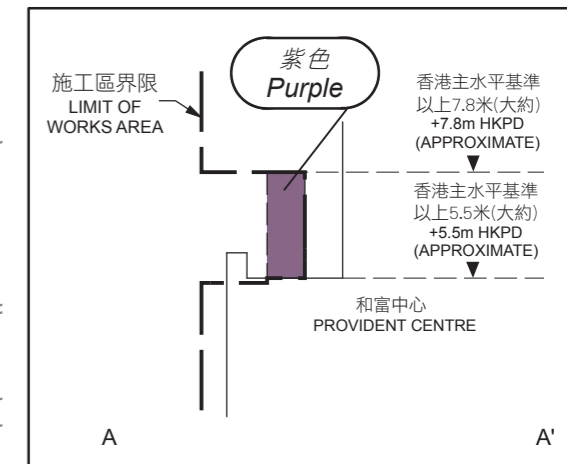

不依比例 NOT TO SCALE

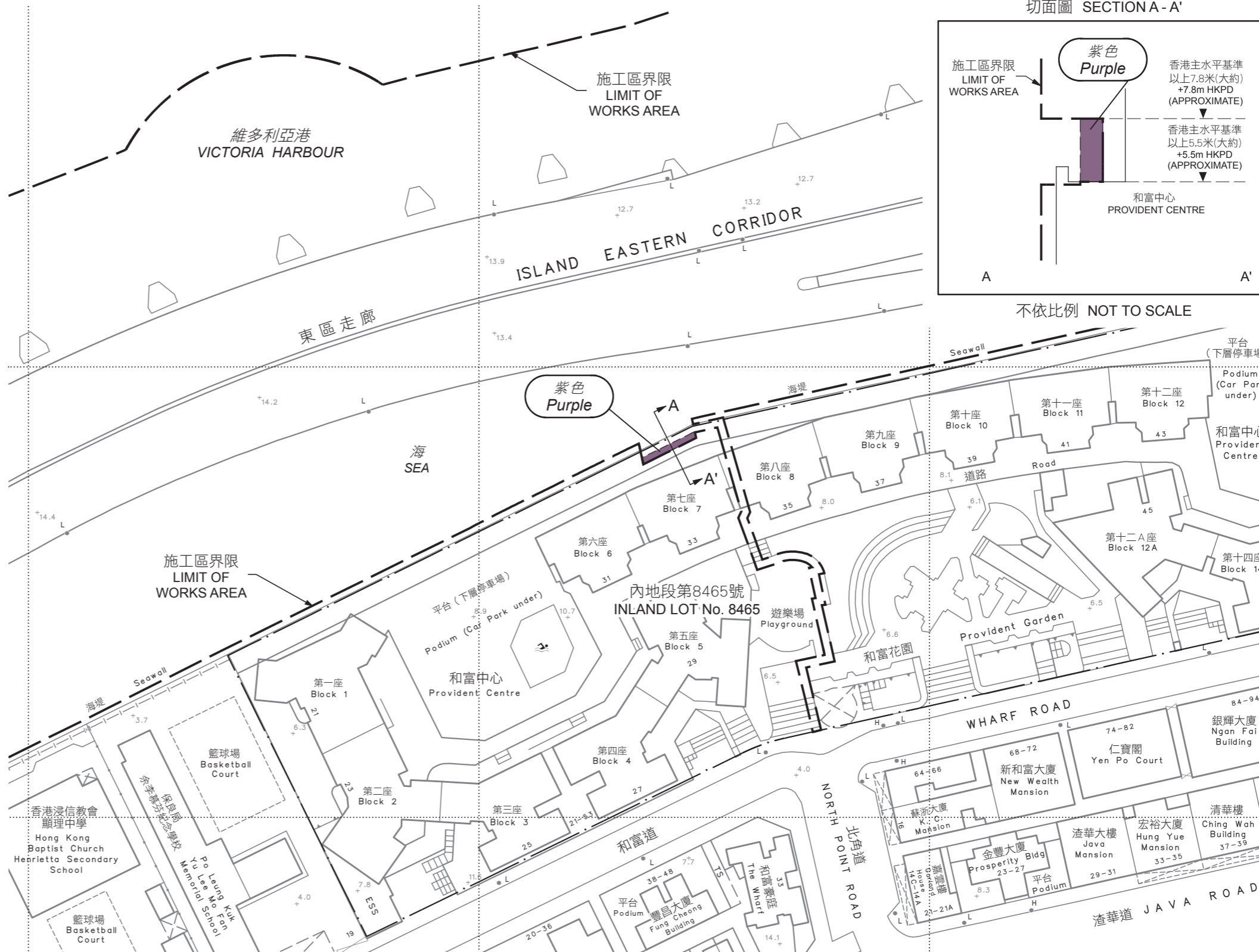

比例尺 SCALE 1:1 000



只作識別用
FOR IDENTIFICATION PURPOSES ONLY